



Ingrassatori Idraulici con Sfiato



Hydraulic Grease Nipples with Breather

Norma UNI 7663 forma A e con filettatura conica 1:16

According to UNI 7663 type A with tapered thread 1:16

1	Acciaio AVP—Zincatura Bianca Fe/Zn 7 II <i>Free Cutting Steel—White Zinc-plated Fe/Zn 7 II</i>
2	Acciaio AVP—Carbonitrurazione 650<HV<750 e Zincatura Iridescente Fe/Zn 7 IV <i>Free Cutting Steel—Carbonitriding 650<HV<750 and Iridescent Zinc-plated Fe/Zn 7 IV</i>

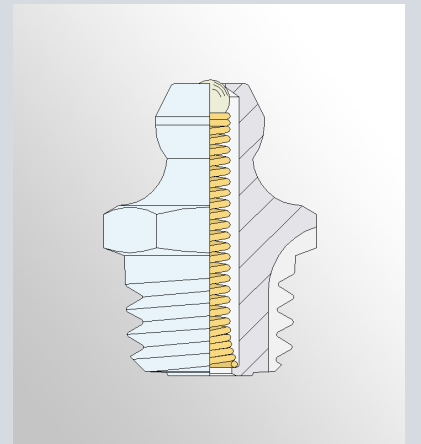

Trattamenti in conformità alle norme: RoHS (2002/95/CE), ELV (2000/53/CE)
 Treatments complying RoHS Standard (2002/95/EC), ELV Standard (2000/53/EC)

Versione Diritta / Straight Version

con Sfiato / with Breather

Disegno <i>Drawing</i>	Fil. <i>Thread</i>	Ch <i>SW</i>	Codice / Code			
			1 <i>Acciaio/Steel Fe/Zn 7 II</i>	2 <i>Acciaio/Steel C. Fe/Zn 7 IV</i>		
	1/4"-28	7	<i>90.15-SF-ZB</i>	<i>90.15-SF-ICH</i>		
	M6x1	7	<i>90.01-SF-ZB</i>	<i>90.01-SF-ICH</i>		
	M8x1	9	<i>70.03-SF-ZB</i>	<i>70.03-SF-ICH</i>		
	M8x1,25	9	<i>70.04-SF-ZB</i>	<i>70.04-SF-ICH</i>		
	R 1/8	11	<i>90.32-SF-ZB</i>	<i>90.32-SF-ICH</i>		
	M10x1	11	<i>90.25-SF-ZB</i>	<i>90.25-SF-ICH</i>		
	M10x1,25	11	<i>90.27-SF-ZB</i>	<i>90.27-SF-ICH</i>		
	1/8"-27	11	<i>CD610-SF-ZB</i>	<i>CD610-SF-ICH</i>		
	R 1/4	14	<i>70.33-SF-ZB</i>	<i>70.33-SF-ICH</i>		

Versione a 45° / 45° Version

con Sfiato / with Breather

Disegno Drawing	Fil. Thread	Ch SW	Codice / Code					
			1 Acciaio/Steel Fe/Zn 7 II	2 Acciaio/Steel C. Fe/Zn 7 IV	3 Acciaio/Steel Geomet 500A	4 AISI 303/A2	5 AISI 316/A4	6 Ottone/Brass
	R 1/8	11	<i>90.52-SF-ZB</i>	<i>90.52-SF-ICH</i>				
	M10x1	11	<i>90.45-SF-ZB</i>	<i>90.45-SF-ICH</i>				
	M10x1,25	11	<i>90.40-SF-ZB</i>	<i>90.40-SF-ICH</i>				
	M10x1,5	11	<i>90.47-SF-ZB</i>	<i>90.47-SF-ICH</i>				
	R 1/4	14	<i>90.53-SF-ZB</i>	<i>90.53-SF-ICH</i>				

Versione a 90° / 90° Version

con Sfiato / with Breather

Disegno Drawing	Fil. Thread	Ch SW	Codice / Code					
			1 Acciaio/Steel Fe/Zn 7 II	2 Acciaio/Steel C. Fe/Zn 7 IV	3 Acciaio/Steel Geomet 500A	4 AISI 303/A2	5 AISI 316/A4	6 Ottone/Brass
	R 1/8	11	<i>90.72-SF-ZB</i>	<i>90.72-SF-ICH</i>				
	M10x1	11	<i>90.65-SF-ZB</i>	<i>90.65-SF-ICH</i>				
	M10x1,25	11	<i>90.60-SF-ZB</i>	<i>90.60-SF-ICH</i>				
	M10x1,5	11	<i>90.67-SF-ZB</i>	<i>90.67-SF-ICH</i>				
	R 1/4	14	<i>90.73-SF-ZB</i>	<i>90.73-SF-ICH</i>				